

## IMPORTANT ROADWORKS INFORMATION

18 May 2026

### Long Reach, The Street, and Rectory Hill, Brightling and Brightling Road, Robertsbridge

Dear Resident / Business owner,

Balfour Beatty is working in partnership with East Sussex County Council to manage the highways service across East Sussex. As part of this, we will be carrying out carriageway patching and clearing debris from the drains on Long Reach, The Street, Rectory Hill, Brightling and Brightling Road, Robertsbridge.

#### When do they start?

Works will be carried out from **Monday 22 June to Thursday 2 July 2026**, between 7pm and 5am, weeknights only, with the roads open as usual during the daytime. If we experience any delays due to unsuitable weather or other unforeseen circumstances, we may need to also work overnight at weekends. Any changes to the dates or times will be displayed on the site advanced warning signs.

#### How will this impact highway users?

**Monday 22 June to Saturday 27 June:** we will be working on Brightling Road, Brightling between the junctions of Deer Park Road and Rectory Hill with our work finishing by 5am, Saturday 27 June.

Access will be restricted to residents while we are working with traffic diverted via Deer Park Road, North Road, B2096/Battle Road, Cackle Stret, Hollingrove Lane, Hollingrove Hill and vice versa.

**Saturday 27 June to Thursday 2 July:** we will be working on Brightling Road, Brightling/Robertsbridge between the junctions of Rectory Hill and Bishops Lane.

Access will be restricted to residents while we are working with traffic diverted via Brightling Road, George Hill, A21, A2100, Chain Lane, North Trade Road, Cackle Street, Hollingrove Lane, Hollingrove Hill and vice versa.

Access for emergency vehicles will be maintained at all times.

For safety, access to properties within the works area will be limited and managed during our working hours. If you need access, please speak to the team on site, as arrangements and routes may change as work progresses. Please bare in mind, there could also be a delay while the area is made safe for you to pass and your vehicle may be escorted by site marshalls. This is for properties with direct access within the closure area only and there will be no through route.

Please be polite and respectful to the site teams, they are working to keep everyone safe.



## Information for residents and businesses

**Parking:** If required, we will put out 'no parking' signs and cones on the site to advise where parking is restricted. Please avoid parking in these locations as it will delay our works.

**Weather:** All of these works are subject to favourable weather conditions, for example heavy rain may affect the progress of the works.

Properties close to the carriageway may experience a temporary disturbance as this can be a noisy process and those properties may experience flashing lights and reversing sirens.

We would like to take this opportunity to apologise in advance for any inconvenience or disruption this work may cause, however this forms part of our continuing improvement for the East Sussex highway network. Should you have any concerns regarding these works, you can contact us at [eshcomms@balfourbeatty.com](mailto:eshcomms@balfourbeatty.com).

For information on roadworks and journey planning, visit [One.Network](https://www.one.network). Please follow us on X (formerly Twitter) [@escroads](https://twitter.com/escroads) or Facebook [@EastSussexHighways](https://www.facebook.com/EastSussexHighways) for updates. If you would like to know more about East Sussex Highways and what we do, please visit our website [www.eastsussexhighways.com](https://www.eastsussexhighways.com).

Thank you,

**East Sussex Highways**

### Map of works areas and diversion route

Report a problem here:



Leave feedback on these works here:

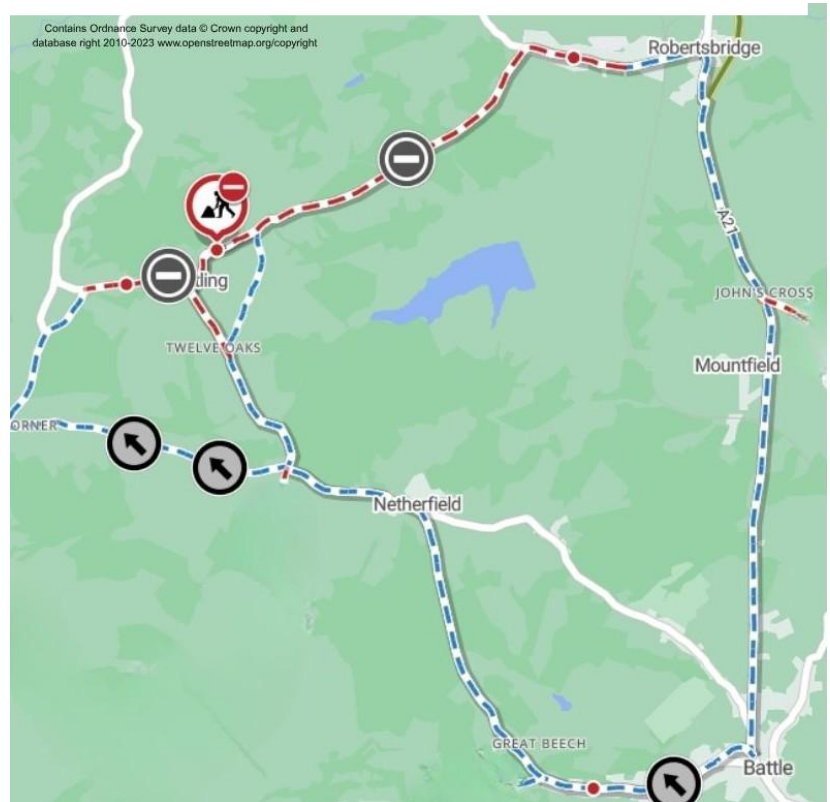

KT



Mailing produced by Leatherhead Print & Mail Centre.  
Part of Britain's Bravest Manufacturing Company | Royal British Legion Industries Social Enterprise  
Telephone 01372 389940 - Email [print@rbl.co.uk](mailto:print@rbl.co.uk)

This paper is 100% recycled

